



Electrolux
PROFESSIONAL

**Modular Cooking Range Line
thermaline 80 - 1200 mm Open
base, 1 Side (H2) - H=550**

ITEM # _____

MODEL # _____

NAME # _____

SIS # _____

AIA # _____



588218 (MA1ADAKOOO)

Open base, one-side
operated - H2

Short Form Specification

Item No. _____

1200 mm wide open base compartment to store pots, pans, sheet pans, etc. with hygienic design and round edges. Unit constructed according to DIN 18860_2 with 70 mm recessed plinth. Internal frame for heavy duty sturdiness in stainless steel. Flat surface construction, easily cleanable. IPX5 water resistant certification. Configuration: One-side operated freestanding base, hygienic class H2.

Main Features

- Open base compartment for storage of pots, pans, sheet pans, etc.
- All major components may be easily accessed from the front.
- [NOT TRANSLATED]

Construction

- Hygienic design of the open base compartment with large round edges.
- IPX5 water resistance certification.
- 2 mm top in 1.4301 (AISI 304).
- Flat surface construction with minimal hidden areas to easily clean all surfaces
- Internal frame for heavy duty sturdiness in stainless steel.

APPROVAL: _____



Experience the Excellence
www.electroluxprofessional.com

Front

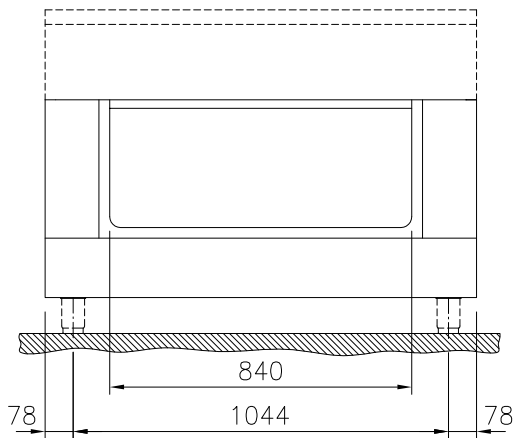

Side

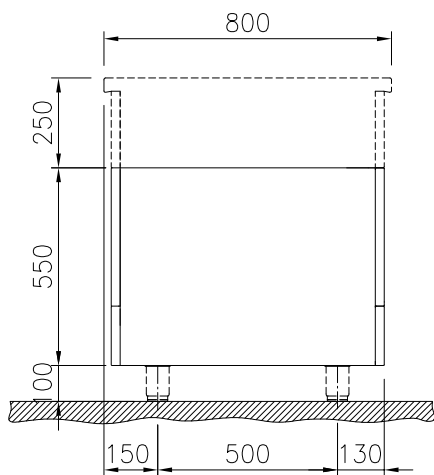

Top

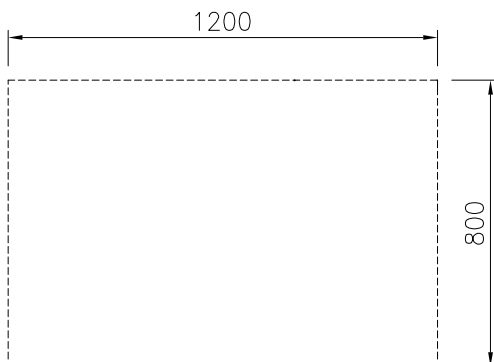

Key Information:

External dimensions, Width:	
588218 (MA1ADAKOOO)	1200 mm
External dimensions, Depth:	800 mm
External dimensions, Height:	550 mm
Cupboard Cavity Dimensions (width):	840 mm
Cupboard Cavity Dimensions (height):	330 mm
Cupboard Cavity Dimensions (depth):	740 mm
Net weight:	26 kg

Optional Accessories

- Stainless steel side panel (12mm), 800x800mm, freestanding PNC 912508 ☐
- Stainless steel front kicking strip, 1200mm width PNC 912602 ☐
- Stainless steel side kicking strips left and right, freestanding, 800mm width PNC 912619 ☐
- Stainless steel side kicking strips left and right, wall mounted, 800mm width PNC 912622 ☐
- Stainless steel side kicking strips left and right, back-to-back, 1600mm width PNC 912625 ☐
- Stainless steel plinth, against wall, 1200mm width PNC 912810 ☐
- Stainless steel plinth, freestanding, 1200mm width PNC 912829 ☐
- Stainless steel panel (12mm) 800x800mm, against wall, left side PNC 913094 ☐
- Stainless steel panel (12mm) 800x800mm, flush-fitting, against wall, right side PNC 913098 ☐
- Back panel, 1200x550mm, for bases and units, one-side operated PNC 913186 ☐
- Stainless steel side panel, left, h=800 PNC 913216 ☐
- Stainless steel side panel, right, h=800 PNC 913217 ☐
- - NOT TRANSLATED - PNC 913239 ☐
- - NOT TRANSLATED - PNC 913257 ☐
- - NOT TRANSLATED - PNC 913264 ☐
- - NOT TRANSLATED - PNC 913266 ☐
- - NOT TRANSLATED - PNC 913273 ☐
- - NOT TRANSLATED - PNC 913274 ☐
- - NOT TRANSLATED - PNC 913279 ☐
- - NOT TRANSLATED - PNC 913669 ☐
- - NOT TRANSLATED - PNC 913685 ☐